

# STEP Digital Families Learning App

## Setting up your student's learner profile on the STEP Learning App



1. To set up your student's learner profile on their iPad, you must have their unique student ID number generated on your teacher dashboard, and have internet connection to activate the profile.
2. Install the STEP Learning App from the App Store onto your student's iPad.  
<https://apps.apple.com/us/app/step-learning-app/id1541179572>
3. Once installation is complete, open the STEP app on the iPad home screen.



4. You will see the learning profiles area of the learning app. There are no profiles on it. Tap the cog icon to open the teacher control panel and add your student.

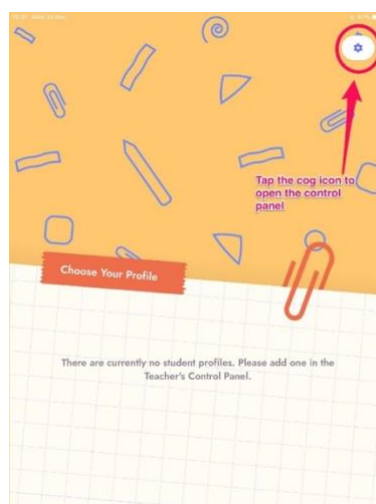

5. Enter the secure PIN received from STEP and tap the forward arrow.



6. Tap 'Create New'. This will bring up a new screen. Add your student's name and unique ID number. Tap 'Save and close'. If you need to add more students to this iPad, for example other siblings, tap 'Create New' and repeat the process.

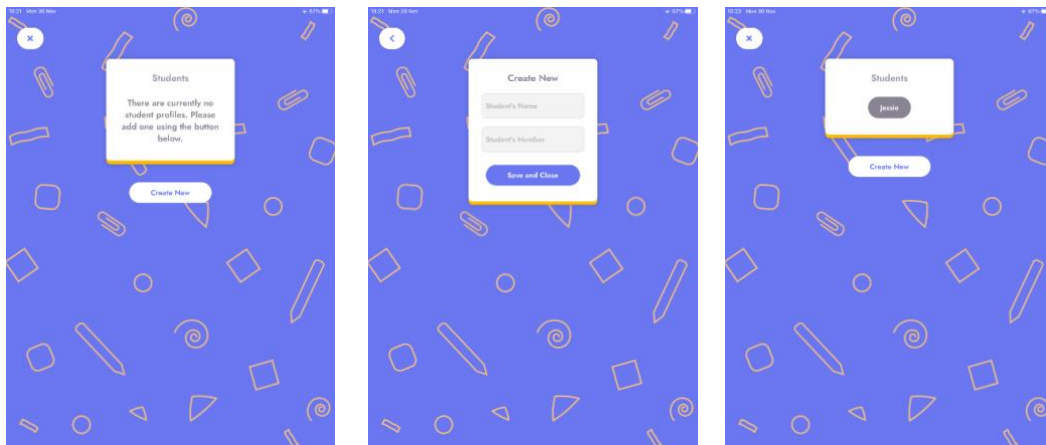

7. You will now see the learner profile. Tap 'Start' to open the learner's profile.

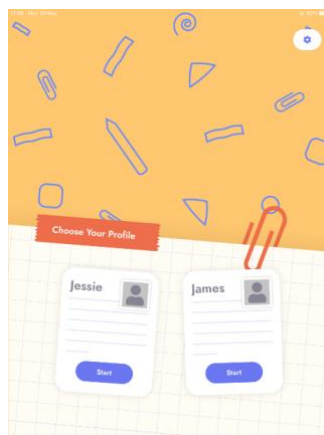

Contact [step@ed.ac.uk](mailto:step@ed.ac.uk) with any queries or visit [www.step.education.ed.ac.uk](http://www.step.education.ed.ac.uk) for instructional videos on using the STEP learning app and teacher dashboard.